

SCALE: 1/12

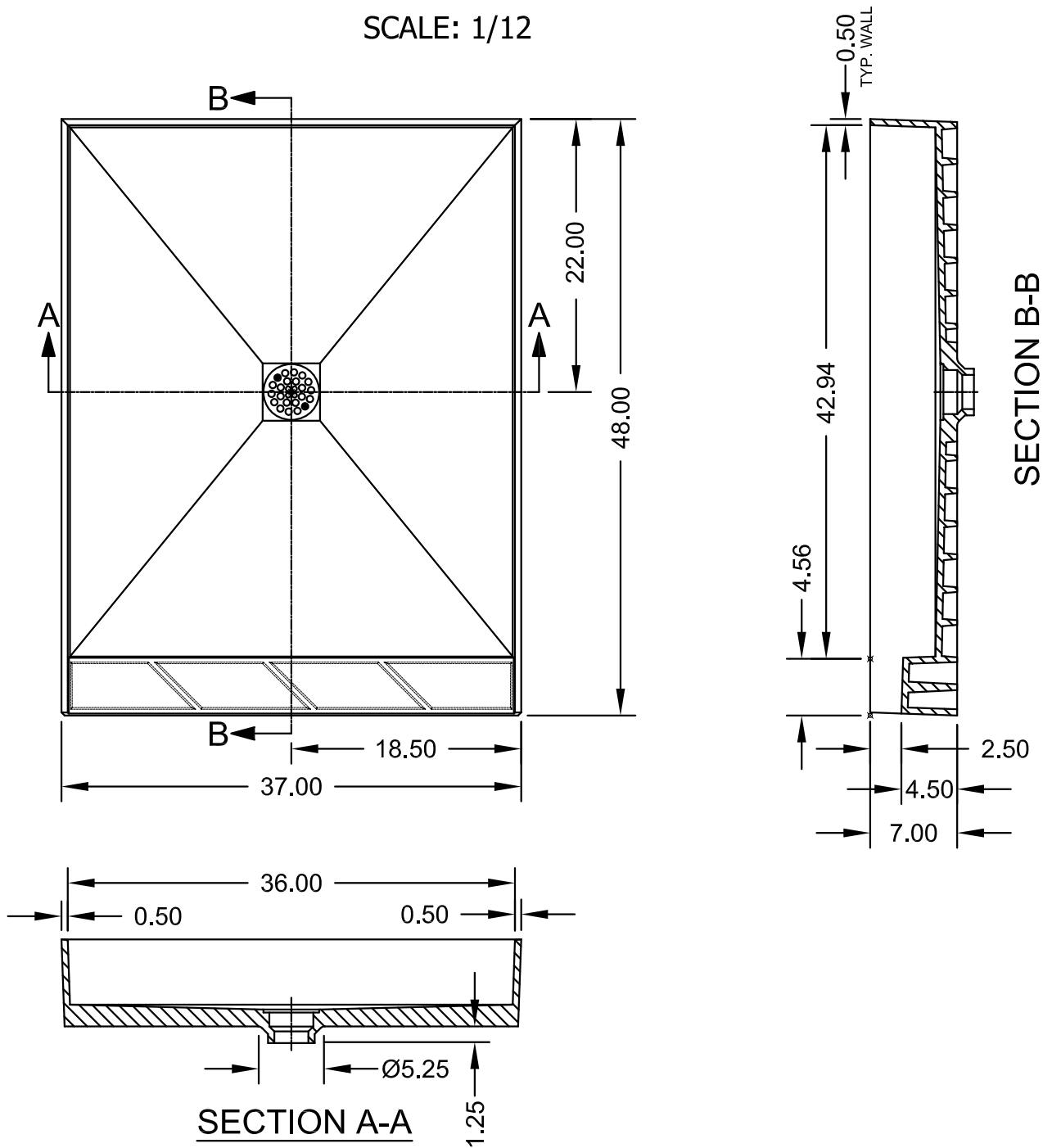

### Product Features:

- .Integrated 2" PVC drain (adaptable to cast iron and ABS)
- .Integrated curb with structural ribbing
- .6" Splash Walls
- .Floor pre-pitched ¼" per foot to drain
- .Tile set directly on pan surface
- .No mud setting or hot mopping required
- .Round polished adjustable drain plate (square plates available)

|  |                    |              |
|--|--------------------|--------------|
|  | ANSI Z124.1-95     | ASTM F462-79 |
|  | ANSI Z124.2-95     | B45.0-02     |
|  | ICC/ANSI A117.1.98 | B45.5-02     |

|           |              |                          |
|-----------|--------------|--------------------------|
| Toll Free | 800.232.6156 | techsupport@tileredi.com |
| Tel:      | 954.323.0125 |                          |
| Fax:      | 954.344.8064 | www.tileredi.com         |

Perfection through Innovation